



Order form

Comfort ACTA-EMBRACE® LTS back support



Dealer Name*:

Account #*:

City, State, Zip*:

Phone:

Email:

ATP:

Rep Name:

P.O. Number:

Quote Number:

Client Reference*:

Client Weight*:

***Required field**

Special considerations that need to be addressed here (e.g., diagnosis):

Notes | Refer to reference pages at end of order form for additional information and images.

ACTA-EMBRACE® LTS Back Support

HCPCS coding: E2620/E2621 Positioning back, planar with lateral supports. Part number: AELTS-BSXXWYYL.

Length								
	10"	12"	14"	16"	18"	20"	22"	24"
22"				\$989.00	\$989.00	\$989.00	\$1,082.00	\$1,082.00
20"			\$989.00	\$989.00	\$989.00	\$989.00	\$1,082.00	\$1,082.00
18"		\$901.00	\$901.00	\$901.00	\$901.00	\$901.00	\$1,012.00	\$1,012.00
16"		\$901.00	\$901.00	\$901.00	\$901.00	\$901.00	\$1,012.00	
14"	\$901.00	\$901.00	\$901.00	\$901.00	\$901.00	\$901.00		
12"	\$901.00	\$901.00	\$901.00	\$901.00	\$901.00			
10"	\$901.00	\$901.00	\$901.00	\$901.00				
Width								

10" length and/or width not available with power mount hardware.

10" length not available with 4 point hardware if using head support.

24" wide back supports require 4 point or power mount hardware.

Cover | Required, choose one.

COMFORT-TEK

COMFORT-TEK

For fluid protection, an easily cleaned surface

NC

STRETCH-AIR

STRETCH-AIR

For comfort and heat dissipation

NC

Hardware | Required, choose one.

Quick Release	Quick Release 2 Point (Q-COMPASS)	Quick Release 4 Point (Q-COMPASS4)	NC
Fixed	Fixed 2 Point (NQ-COMPASS)	Fixed 4 Point (NQ-COMPASS4)	NC
Power Mount	Permobil w/ Corpus 3G (PMB-PERMOBIL)	Quantum w/ Tru Balance 3 (PMB-QUANTUM)	\$52.00
	Quickie w/ 3.7 Power (PMB-QUICKIE)	Avid Rehab w/ Power T & R (PMB-AVID)	
	ROVI w/ Motion Concepts (PMB-ROVI)		

**Using Power Mount hardware on ROVI requires mounting to the recessed planar interface plate available when ordering the Motion Concepts seating system. Drilling is required for mounting.*

Lateral trunk support | Required, choose one. Includes moldable support and fixed hardware.

3" L x 4" D	COMFORT-TEK (LAT-3L4D-COMFORT-TEK)	STRETCH-AIR (LAT-3L4D-STRETCH-AIR)	NC
4" L x 5" D	COMFORT-TEK (LAT-4L5D-COMFORT-TEK)	STRETCH-AIR (LAT-4L5D-STRETCH-AIR)	NC
4" L x 6.5" D	COMFORT-TEK (LAT-4L6D-COMFORT-TEK)	STRETCH-AIR (LAT-4L6D-STRETCH-AIR)	NC
5" L x 6.5" D	COMFORT-TEK (LAT-5L6D-COMFORT-TEK)	STRETCH-AIR (LAT-5L6D-STRETCH-AIR)	NC

Additional lateral trunk support hardware | Optional, priced per selection.

Swing-away hardware	Left (BL-LTS-GT2SAS-LH)	Right (BL-LTS-GT2SAS-RH)	\$339.00	E1028
	Extra Left (BL-LTS-GT2SAS-LH)	Extra Right (BL-LTS-GT2SAS-RH)		
Extra hardware link	Left (BL-LTS-GT2LINK)	Right (BL-LTS-GT2LINK)	\$43.00	
	Extra Left (BL-LTS-GT2LINK)	Extra Right (BL-LTS-GT2LINK)		
Hardware cover	Left (BL-LTS-HCOVER)	Right (BL-LTS-HCOVER)	\$31.00	
	Extra Left (BL-LTS-HCOVER)	Extra Right (BL-LTS-HCOVER)		
Winter/Summer hardware	Left (BL-LTS-HWSAE-LH)	Right (BL-LTS-HWSAE-RH)	\$175.00	

Strap guide extension bracket

CHG2-EB1	Extra small Up to 1 3/4" with webbing	\$65.00
CHG2-EB2	Small Up to 2 1/4" with webbing	\$65.00

Accessories | Optional

PV-FLAP	Privacy Flap Connects with hook & loop attachment	\$44.00
---------	---	---------

BodiLink premium head support & hardware

Optional, if selecting must choose pad size, foam selection, cover, and mounting hardware.

Pad size and foam selection

	Soft	Extra soft		
Pad size				
6"W x 3"L	BL-HSP1-6W3L	BL-HSP2-6W3L	\$269.00	E0955
8"W x 4"L	BL-HSP1-8W4L	BL-HSP2-8W4L	\$269.00	E0955
10"W x 5"L	BL-HSP1-10W5L	BL-HSP2-10W5L	\$269.00	E0955
12"W x 5"L	BL-HSP1-12W5L	BL-HSP2-12W5L	\$269.00	E0955
14"W x 5"L	BL-HSP1-14W5L	BL-HSP2-14W5L	\$269.00	E0955
18"W x 5"L	BL-HSP1-18W5L	BL-HSP2-18W5L	\$269.00	E0955

Cover options

COMFORT-TEK	COMFORT-TEK <i>For fluid protection & an easily cleaned surface</i>	NC
STRETCH-AIR	STRETCH-AIR <i>For comfort & heat dissipation</i>	NC
GLIDEWEAR	GlideWear <i>For skin protection & shear reduction. NOT fluid resistant</i>	\$30.00

PT hardware, removable

BL-HS-PT1RMMID6	Mid 6	\$254.00	E1028
BL-HS-PT1RMLAT6	Lat 6	\$295.00	E1028
BL-HS-PT1RMMID8	Mid 8	\$254.00	E1028
BL-HS-PT1RMLAT8	Lat 8	\$295.00	E1028
BL-HS-PT1RMMAX8	Max 8	\$372.00	E1028

Stem length option | *For removable PT hardware only.*

HS-STEM-7	Standard 7" stem	NC
HS-STEM-3	3"stem (recommended for use with power mounting where there may be constraints)	NC

PT hardware, flip down | *Flip down hardware has 7" stem.*

BL-HS-PT1FDMID6	Mid 6	\$310.00	E1028
BL-HS-PT1FDLAT6	Lat 6	\$353.00	E1028
BL-HS-PT1FDMID8	Mid 8	\$310.00	E1028
BL-HS-PT1FDLAT8	Lat 8	\$353.00	E1028
BL-HS-PT1FDMAX8	Max 8	\$405.00	E1028

Mounting option

HS-MB-POSTA	Posterior A	NC
-------------	--------------------	----

Additional hardware options | *Priced per selection.*

Extra link for PT hardware	Extra 2" link (BL-HS-PT1LINK2)	Extra 3" link (BL-HS-PT1LINK3)	\$65.00
	Extra 4" link (BL-HS-PT1LINK4)		
BL-HS-52WINGA1	Tool-less wing lock for PT hardware <i>Enter desired number.</i>		\$25.00
BL-HS-SPCRA	1/4 Spacer Plate		\$43.00

Additional Order Instructions (for Permobil):

Notes & Comments (not for Permobil):

Chair Order Policy:

You are highly encouraged to contact Permobil Sales with ANY questions regarding proper completion of our order forms at 1-800-736-0925. The order cannot be processed without the following:

- The client's name or code and the client's weight
- The order form must also be signed by a person authorized by your company to acknowledge the items selected. Permobil is not responsible for configuration or size discrepancies resulting from customer errors on the order form.
- Order confirmations will be provided by Permobil summarizing the items selected. Please review this carefully.
- Once the order is shipped, any changes are subject to the returns policy and may be prohibited.

Order Acknowledgement:

I, _____, am an agent of the medical equipment provider named on this order form and I have the authority to contract for the purchase of powered wheelchairs and related parts on behalf of said provider. I acknowledge that I have reviewed this order and that it is complete and accurate to the best of my knowledge. I further acknowledge that any changes to this order after submission of this order form are subject to the returns policy and may carry additional charges.

Signed: _____

Printed Name: _____

Title: _____

Date: _____

NOTE: All specifications and prices are subject to change without notice. Please note that prices displayed are only valid if ordered with the wheelchair. Any parts ordered for service or future alterations will carry different pricing and warranty. The HCPCS codes provided are not intended to be billing or legal advice, rather our interpretation of the code definitions. Use of the codes does not ensure coverage or payment for the item. For coverage information, verify the policy of the appropriate payer.

References

Section 1 | Hardware options

Compass 4 quick release

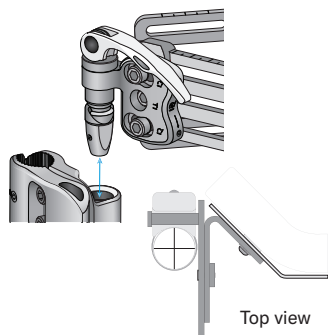

Compass 4 fixed

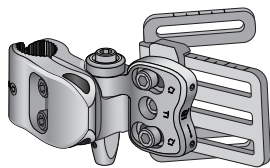

Compass power mount

Power mount hardware has 8" of height adjustment in 1/2" increments without using tools.

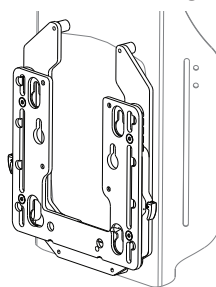

4-point

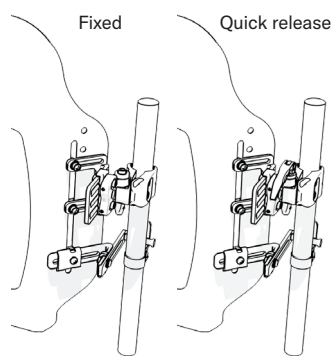

Section 2 | Accessories

Privacy flap

This flap connects with hook & loop attachment between the seat and the back for added privacy.

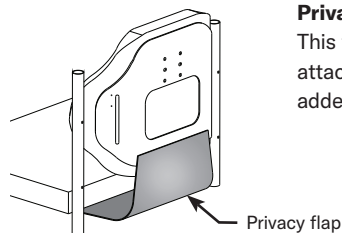

Strap guide extension bracket

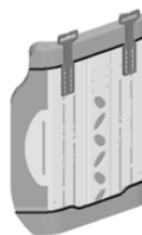

Section 3 | BodiLink lateral trunk support hardware

GT2 mounting hardware, slot mount, swing-away

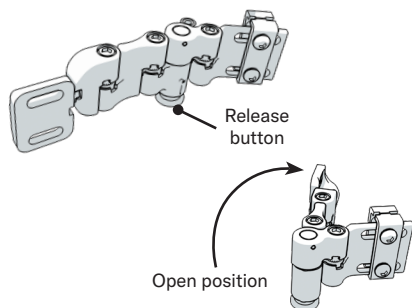

GT2 mounting hardware, slot mount, fixed

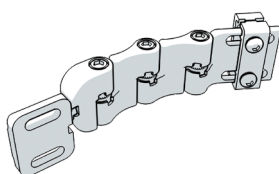

GT2 mounting hardware, track mount, swing away

Track mount hardware is only available when using Compass 4 hardware. If using compass power mount hardware, select slot mounting hardware.

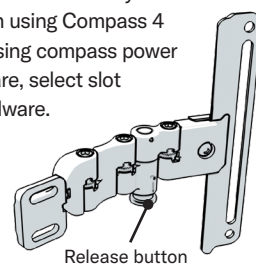

Section 4 | BodiLink lateral trunk support pads

Premium pads, supportive

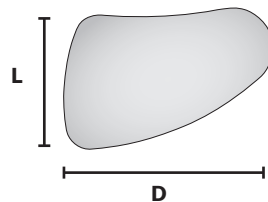

Premium pads, active

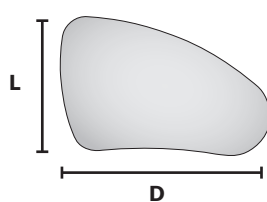

Basic pads, supportive

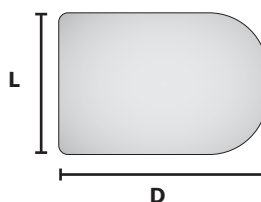

Basic pads, active

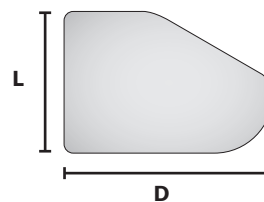

Section 5 | Bodilink lateral trunk support additional hardware options

Extra hardware links

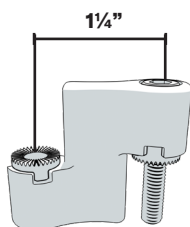

Long mounting bracket

Adds 1" of additional adjustment per bracket

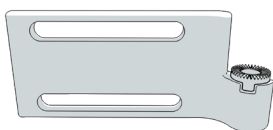

Hardware cover

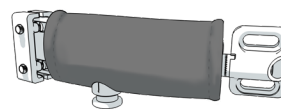

Section 6 | Bodilink head support pads

Basic pad sizes

W			
L	6W x 5L	L	12W x 6L
L	8W x 5L	L	14W x 6L
L	10W x 6L	L	18W x 6L
		W	

Length(L) refers to the actual dimension of the support from bottom to top edge



Basic head support pads can be formed to any shape using the moldable steel insert inside the pad.

Premium pad sizes

W			
L	6W x 3L	L	12W x 5L with adjustable wings
L	8W x 4L	L	14W x 5L with adjustable wings
L	10W x 5L with adjustable wings	L	18W x 5L with adjustable wings
		W	

Length(L) refers to the actual dimension of the support from bottom to top edge



Premium head support pad angles can be formed by adjusting the plates in the pad

Section 7 | BodiLink head support hardware options

GT hardware, removable

Range of motion

GT model	Total # of links	Total link length	Max. anterior reach	Max. posterior reach	Max. lateral reach
LAT	5	10.5"	10"	2"	7.5"
MID	3	8.5"	8"	2"	N/A

GT hardware, LATERAL



GT hardware, MID-LINE



BodiLink head support hardware: PT hardware, removable

Range of motion

PT model	Total # of links	Total link length	Max. anterior reach	Max. posterior reach	Max. lateral reach
MID 6	2	6"	5.5"	1"	N/A
LAT 6	3	6"	5.5"	1"	6"
MID 8	2	8"	7.5"	1"	N/A
LAT 8	3	8"	7.5"	1"	8"
MAX 8	4	8"	7.5"	3"	8"

PT hardware, MID 6

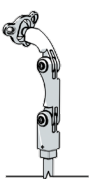

PT hardware, MID 8



PT hardware, LAT 6

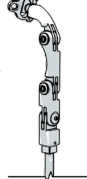

PT hardware, LAT 8

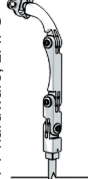

PT hardware, MAX 8



BodiLink head support hardware: PT hardware, removable stem length option

3" stem is recommended for use with power mounting where there may be special constraints with power chair functions

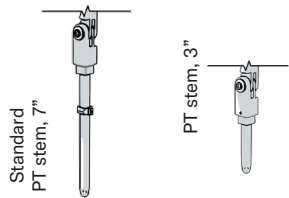

Mounting options

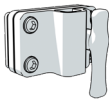

Mounting block posterior A
For Acta-Back®, Acta-Embrace™, Visco-Back, and Acta-Relief with Power Mount Only

Extra hardware

¼" spacer plate

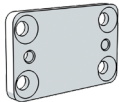

Extra links: 2", 3", 4"

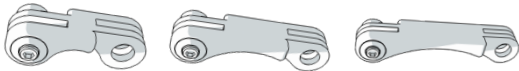

Tool-less wing lock

