

# BODILINK® HEAD SUPPORT BASIC ORDER FORM

**permobil**

SEATING + POSITIONING

HCPCS CODING: E0955 - CUSHIONED HEADREST  
HCPCS CODING: E1028 - GT REMOVABLE HARDWARE

Company Name/ACCT #: \_\_\_\_\_

P.O. Number: \_\_\_\_\_

Requested By: \_\_\_\_\_

Phone: \_\_\_\_\_ Fax: \_\_\_\_\_

Email: \_\_\_\_\_

Ship To: \_\_\_\_\_

Patient Reference: \_\_\_\_\_



GT Lateral Hardware  
Shown on Acta-Back®

For best results, do not fill out in your browser. Interactive form should be completed using Adobe Reader after saving to your local drive. Then email or print and fax to Customer Support at orders.comfort@permobil.com or 1.406.522.8563.

*\*DO NOT SEND PATIENT PROTECTED HEALTH INFORMATION. IT IS NOT NEEDED TO MAKE THE PRODUCT YOU ARE REQUESTING.\**

## 1 BODILINK® HEAD SUPPORT PAD

- You may make one selection per column.
- Choose pad size in 1.1.
- Choose a cover material in 1.2.

### 1.1 BASIC PAD SIZE

HCPCS CODING: E0955 MSRP \$129.00

Length (L) refers to the actual size dimension of the support from bottom to top edge.

|   | W        |               |
|---|----------|---------------|
| L | 6W x 5L  | BL-HSP3-6W5L  |
| L | 8W x 5L  | BL-HSP3-8W5L  |
| L | 10W x 6L | BL-HSP3-10W6L |
| L | 12W x 6L | BL-HSP3-12W6L |
| L | 14W x 6L | BL-HSP3-14W6L |
| L | 18W x 6L | BL-HSP3-18W6L |



Basic head support pads can be formed to any shape using the moldable steel insert inside the pad.

### 1.2 BASIC PAD COVER MATERIAL

**COMFORT-TEK** FOR FLUID PROTECTION & AN EASILY CLEANED SURFACE.

**STRETCH-AIR** FOR PATIENT COMFORT & HEAT DISSIPATION.

|  |                           |
|--|---------------------------|
|  | Comfort-Tek (COMFORT-TEK) |
|  | Stretch-Air (STRETCH-AIR) |

## 2 BODILINK™ HEAD SUPPORT HARDWARE

- You may make one selection per column in either.
- Choose which mounting block option you require in 2.2.

### 2.1 GT HARDWARE, Removable

HCPCS E1028

#### RANGE OF MOTION

| GT MODEL | TOTAL # OF LINKS | TOTAL LINK LENGTH | MAX. ANTERIOR REACH | MAX. POSTERIOR REACH | MAX. LATERAL REACH |
|----------|------------------|-------------------|---------------------|----------------------|--------------------|
| LAT      | 5                | 10.5"             | 10"                 | 2"                   | 7.5"               |
| MID      | 3                | 8.5"              | 8"                  | 2"                   | N/A                |

| STYLE    | MSRP     | PART NUMBER      |
|----------|----------|------------------|
| LATERAL  | \$228.00 | (BL-HS-GT3RMLAT) |
| MID-LINE | \$191.00 | (BL-HS-GT3RMMID) |

GT HARDWARE, LATERAL



GT HARDWARE, MID-LINE



## 2.2 HEAD SUPPORT MOUNTING OPTION



**MOUNTING BLOCK-POSTERIOR A or B**  
**A:** For Acta-Back®, Acta-Embrace™, Visco-Back, and Acta-Relief with Power Mount Only  
**B:** For Radius Back® or OEM wood/t-nut back supports

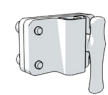

**MOUNTING BLOCK-ANTERIOR A**  
 For AGILITY and other OEM back supports

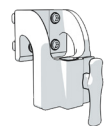

**MOUNTING BLOCK-PERMOBIL A**  
 For Permobil Corpus 3G Back Supports (23"- 28"H)

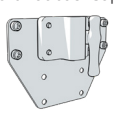

**MOUNTING BLOCK-QUANTUM A**  
 For Quantum Tru-Comfort back supports

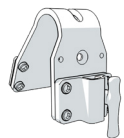

**MOUNTING BLOCK-PERMOBIL B**  
 For Permobil Corpus 3G Back Supports (20"H)

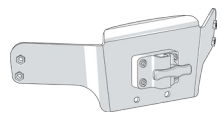

**BRACKET WITH MOUNTING BLOCK-ACTA-RELIEF™**  
 18W Shown Above  
 For Non-Power Mount Only.

| MOUNTING BLOCK OR BRACKET WITH MOUNTING BLOCK | MSRP    | PART NUMBER   |
|---|---------|---------------|
| POSTERIOR A MOUNTING BLOCK                    | \$0.00  | (HS-MB-POSTA) |
| POSTERIOR B MOUNTING BLOCK                    | \$0.00  | (HS-MB-POSTB) |
| ANTERIOR A MOUNTING BLOCK                     | \$0.00  | (HS-MB-ANTA)  |
| QUANTUM A MOUNTING BLOCK                      | \$90.00 | (HS-MB-PW1A)  |
| PERMOBIL A MOUNTING BLOCK                     | \$90.00 | (HS-MB-PW2A)  |
| PERMOBIL B MOUNTING BLOCK                     | \$90.00 | (HS-MB-PW2B)  |
| *ACTA-RELIEF™ 14W BRACKET WITH MOUNTING BLOCK | \$72.00 | (HS-MB-AR14W) |
| *ACTA-RELIEF™ 16W BRACKET WITH MOUNTING BLOCK | \$72.00 | (HS-MB-AR16W) |
| *ACTA-RELIEF™ 18W BRACKET WITH MOUNTING BLOCK | \$72.00 | (HS-MB-AR18W) |
| *ACTA-RELIEF™ 20W BRACKET WITH MOUNTING BLOCK | \$72.00 | (HS-MB-AR20W) |

\*For Acta Relief™, includes mounting bracket and POSTA block.  
 If you already have an Acta-Relief™ head support bracket, order POSTA Block

## 3 HEAD SUPPORT ADDITIONAL MOUNTING HARDWARE

### 3.1 EXTRA MOUNTING HARDWARE

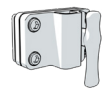

**MOUNTING BLOCK-POSTERIOR A or B**  
**A:** For Acta-Back®, Acta-Embrace™, Visco-Back, and Acta-Relief with Power Mount Only  
**B:** For Radius Back® or OEM wood/t-nut back supports

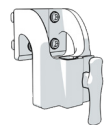

**MOUNTING BLOCK-PERMOBIL A**  
 For Permobil Corpus 3G Back Supports (23"- 28"H)

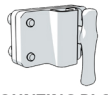

**MOUNTING BLOCK-ANTERIOR A**  
 For AGILITY and other OEM back supports

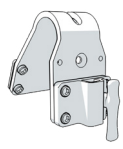

**MOUNTING BLOCK-PERMOBIL B**  
 For Permobil Corpus 3G Back Supports (20"H)

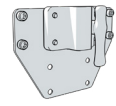

**MOUNTING BLOCK-QUANTUM A**  
 For Quantum Tru-Comfort back supports

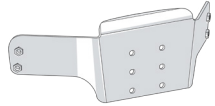

**BRACKET-ACTA-RELIEF™**  
 18W Shown Above

| MOUNTING BLOCK OR BRACKET  | MSRP     | PART NUMBER     |
|----------------------------|----------|-----------------|
| POSTERIOR A MOUNTING BLOCK | \$52.00  | (BL-HS-MBPOSTA) |
| POSTERIOR B MOUNTING BLOCK | \$52.00  | (BL-HS-MBPOSTB) |
| ANTERIOR A MOUNTING BLOCK  | \$52.00  | (BL-HS-MBANTA)  |
| QUANTUM A MOUNTING BLOCK   | \$90.00  | (BL-HS-MBPW1A)  |
| PERMOBIL A MOUNTING BLOCK  | \$90.00  | (BL-HS-MBPW2A)  |
| PERMOBIL B MOUNTING BLOCK  | \$90.00  | (BL-HS-MBPW2B)  |
| *ACTA-RELIEF™ 14W BRACKET  | \$152.00 | (BL-HS-AR14W)   |
| *ACTA-RELIEF™ 16W BRACKET  | \$152.00 | (BL-HS-AR16W)   |
| *ACTA-RELIEF™ 18W BRACKET  | \$152.00 | (BL-HS-AR18W)   |
| *ACTA-RELIEF™ 20W BRACKET  | \$152.00 | (BL-HS-AR20W)   |

\*Bracket only, does not include mounting block.



| ADDITIONAL        | MSRP         |
|-------------------|--------------|
| 1/4" SPACER PLATE | \$37.00/each |

| EXTRA PART    |
|---------------|
| (BL-HS-SPCRA) |