

EXTERNAL FIXATOR LEG REST

Parts Included:

- 2 - 1/4-20 x .875" Socket Head Screws
- 2 - 1/4-20 x 1.125" Socket Head Screws
- 2 - 1/4-20 x .625 Button Head Screws
- 1 - 3/16 Hex Key
- 1 - 5/32 Hex Key
- 1 - 3mm Hex Key

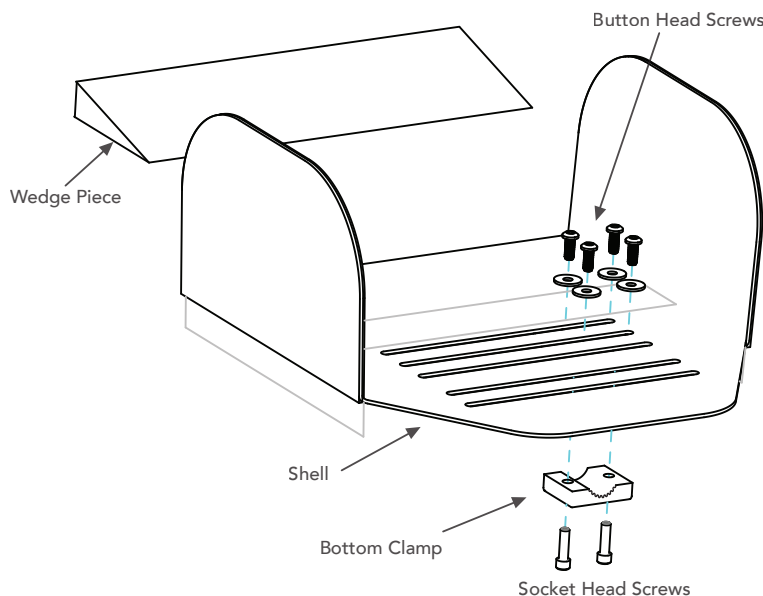
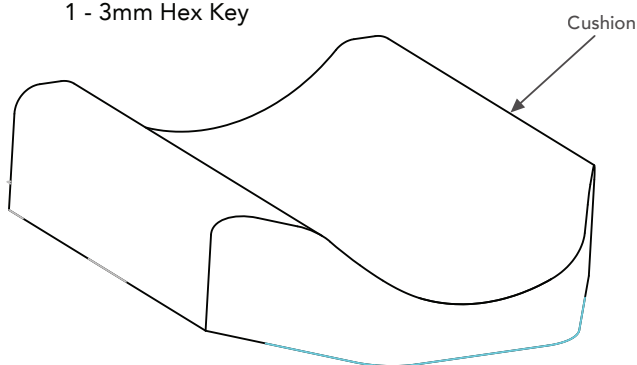

- 1** Remove the leg rest cushion.
- 2** Remove the bottom clamp by loosening the 1/4-20 x .875" socket head screws with the 3/16" hex key.
- 3** Align the shell on the Elevating Leg Rest to the desired distance from the seat cushion. Once in place, lock the shell by bolting the bottom clamp on the Elevating Leg Rest with the 1/4-20 x .875" socket head screws. For Elevating Leg Rests with larger poles, use the 1/4-20 x 1.125" socket head screws from the kit bag.
- 4** If the shell cannot reach the required distance from the seat cushion, remove the clamp assembly by loosening the 1/4-20 x .625" button head screws with the 5/32 hex key and mount it to one of the other open slots.
- 5** Loosen the 1/4-20 x .625" button head screws with the 5/32 hex key in kit bag.
- 6** Slide the shell left or right through the open slots to align with leg. Lock the shell in place by tightening the 1/4-20 x .625 button head screws.
- 7** Once everything is locked in place, securely fasten two tube clam locking screws using 3mm Hex Key. Attach the leg rest cushion back on the shell.
- 8** If the shell is needed for the lower part of the leg and the front of the cushion needs to be slightly elevated, insert the foam wedge piece found in the kit bag. To insert the wedge piece, remove cushion, and remove the paper on the adhesive side of the wedge. Stick the wedge piece on the shell in the desired location and place the cushion back on to the shell.